

SP330M6-60LB SERIES

L Series Mono-crystalline 60Cells 315 W-330W Black Module



10-year product workmanship warranty



10-year guarantee for 90% rated power



25-year guarantee for 80% rated power

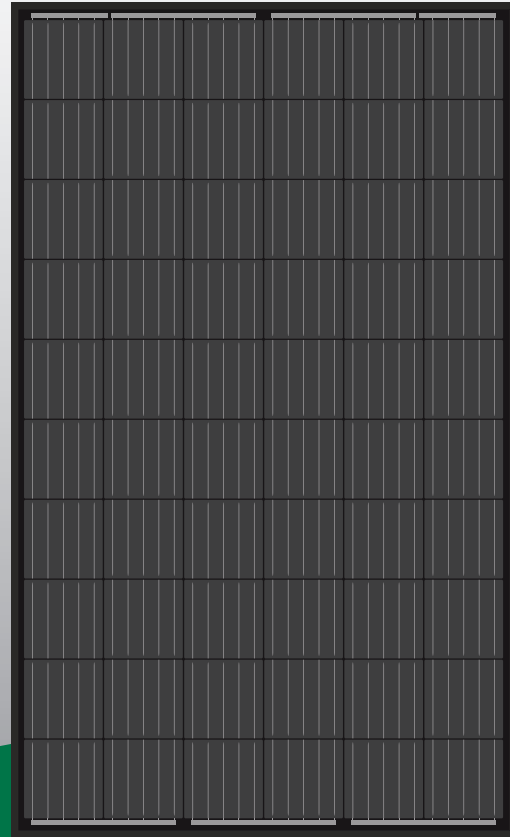

Excellent power generation performance
Guaranteed 0~+5W positive rated power tolerance ensures more power generation every day



Long weather resistance
Excellent anti-PID(Potential Induced Degradation)
Certified in fireproofing for safety



Stable mechanical performance
Passed rigorous hail test
Withstands 5400Pa snow and 2400Pa wind loads



Lower temperature coefficient
Improved temperature coefficient decreases power loss in the high temperature application.



Low-light Performance
Advanced glass and solar cell surface texturing allow for excellent performance in low-light environments.



Superior quality control
ISO 9001:2015 Quality Management System
100% EL and appearance inspection

ELECTRICAL DATA(STC)

Module	SPxxxM6-60LB(xxx=315,320,325,330)			
Peak Power Watts(Pmax/W)	315	320	325	330
Power Output Tolerance(W)	0 ~ +5			
Maximum Power Voltage(Vmp/V)	33.2	33.4	33.6	33.8
Maximum Power Current(Impp/A)	9.49	9.59	9.68	9.77
Open Circuit Voltage(Voc/V)	40.7	40.9	41.1	41.3
Short Circuit Current(Isc/A)	10.04	10.15	10.20	10.31
Module Efficiency(%)	18.88%	19.18%	19.48%	19.78%

STC:Irradiance 1000W/m²,Cell Temperature 25°C,Air Mass AM1.5.

*Measuring tolerance: ±3%.

ELECTRICAL DATA(NOCT)

Maximum Power(Pmax/W)	235	239	242	246
Maximum Power Voltage(Vmp)	31.2	31.4	31.6	31.8
Maximum Power Current(Impp)	7.56	7.62	7.66	7.74
Open Circuit Voltage(Voc)	37.6	37.8	38.0	38.2
Short Circuit Current(Isc)	8.33	8.44	8.54	8.65

NOCT:Irradiance 800W/m²,Ambient Temperature 20°C,Wind Speed 1m/s.

MECHANICAL DATA

Solar Cells	Mono PERC 158.75 × 158.75 mm (6 inches)
Cell Orientation	60 cells (6 × 10)
Module Dimensions	1665 × 1002 × 35 mm (65.5 × 39.45 × 1.38 inches)
Weight	19.0 kg (41.9 lb)
Glass	3.2 mm (0.13 inches), High Transmission, AR Coated Tempered Glass
Backsheet	Black
Frame	Black Anodized Aluminium Alloy
Junction Box	IP 67
Cables	4.0mm ² 1000 mm (39.4 inches)
Connector	MC4

TEMPERATURE RATINGS

NOCT (Nominal Operating Cell Temperature)	45°C (±2°C)
Temperature Coefficient of Pmax	- 0.37%/°C
Temperature Coefficient of Voc	- 0.28%/°C
Temperature Coefficient of Isc	+0.048%/°C

MAXIMUM RATINGS

Operational Temperature	-40~+85°C
Maximum System Voltage	1000V DC (IEC) 1000V DC (UL)
Max Series Fuse Rating	20A

WARRANTY

10 year Product Workmanship Warranty

25 year Linear Power Warranty

(Please refer to product warranty for details)

PACKAGING CONFIGURATION

Modules per box: 30 pieces

Modules per 40' container: 840 pieces

DIMENSIONS OF PV MODULE(mm)

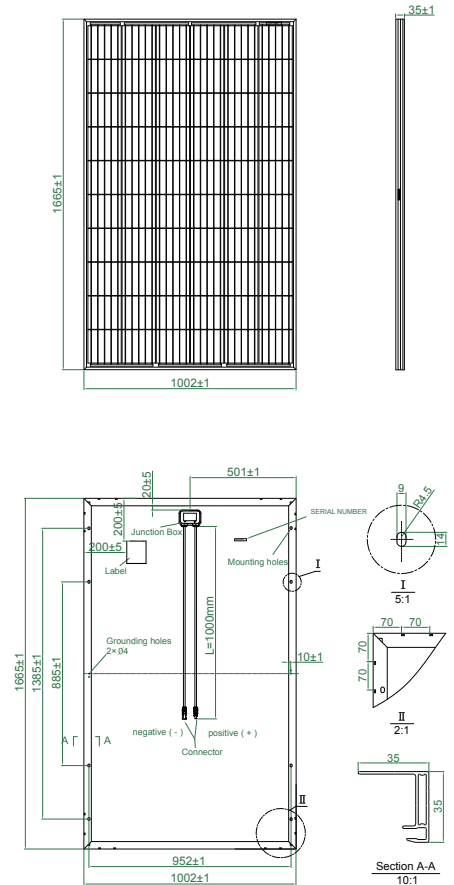

* All Dimensions in mm.

* The above drawing is a graphical representation of the product. For engineering quality drawings please contact SUNPAL.

I-V CURVES OF PV MODULE

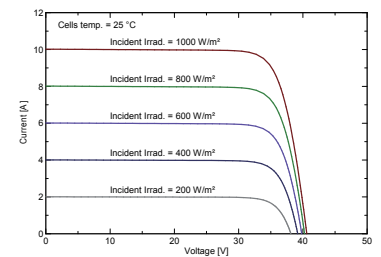

P-V CURVES OF PV MODULE

